

MADE IN GERMANY



**ELEKTROKONTAKT**

Fascinating Electrotechnics



# proboxx

synergy of design and function



1-2-3 | modern  
versatile  
individual



# → Enclosure series proboxx

Modern, elegant and compact enclosure with a maximum of flexibility

- **Empty enclosures** page 10
- **M12 connection** page 11
- **IO-Link** page 15
- **AS-Interface** page 19
- **sWave® radio technology** page 23



## → The proboxx in detail

Particular attention was devoted to the design of the proboxx. Therefore, the screw fitting was deliberately placed on the bottom side, so the enclosure's appearance is not disturbed by exposed screw heads. This aesthetic detail corresponds with the added value of safety: The enclosure can not be opened without dismounting it. For the labelling of the pushbuttons and switches special labels have been developed which fit perfectly into the design and can be fixed easily by clipping on. The inscription is custom-made and engraved by lasering.

- high-quality, stable enclosure made of polyamide
- appealing design
- innovative mounting mechanism for base, wall and profile mounting
- asymmetrical placement on guard lockings
- screw fitting on the bottom
- labels to clip on (laser marked)
- degree of protection IP65
- dimensions
  - width 52 mm
  - height 44 mm
  - length 69 mm, 105 mm, 141 mm, 177 mm
- pushbuttons and switches
  - pilot lights
  - pushbuttons
  - selector/key switches
  - emergency-stop

## → proboxx: Synergy of design and function

Flexible, functional und elegant - these are the characteristics featuring our new enclosure series proboxx made in Dürmentingen. With the new product line we - the expert for pushbuttons and switches - are complementing our portfolio of enclosures by a particularly classy and also practical variant making daily work easier.

We currently offer the proboxx as empty enclosure or also as assembled variant. The assembled variant is available for four different systems.

- Empty enclosure
- Assembled M12 enclosure
- Assembled IO-Link enclosure
- Assembled AS-Interface enclosure
- Assembled enclosure with sWave® radio technology





### **How to configure and order my proboxx**

Orders and individual assemblies of the proboxx can be submitted via the new Schlegel online configurator for enclosures. Based on your requirements, you can select an empty enclosure or an assembled one and choose the most suitable assembly for your application from a variety of sizes and systems.

→ [proboxx.schlegel.biz](https://proboxx.schlegel.biz)



### **Get started with the startboxx**

Would you like to get familiar with the proboxx now? Then simply order our startboxx! The startboxx is a fully functional proboxx equipped with 3 pushbuttons and switches. The proboxx is easy to connect via the M12 connector and can be used immediately.

### → Simple

Thanks to the new innovative mounting mechanism the enclosures are quick and easy to assemble. The enclosure is securely fixed by simply sliding and snapping it in.



### → Functional

- direct integration in IO-Link or AS-Interface systems
- asymmetric fixing for safety gates
- optional, flexible labelling option



### → Plug & Work

Simply to connect with M12 connector, no wiring necessary.



### → flexible

- up to 4 holes for pushbuttons and switches
- various connection options (M12, M16 cable gland, radio system)
- available as pre-equipped or empty enclosure



### → Valuable

Appealing, high-quality and modern design



### → Reliable

- stable plastic enclosure
- degree of protection IP65

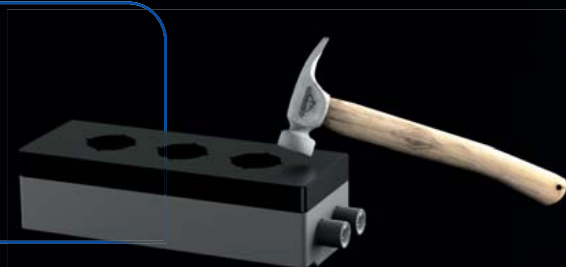





### → Empty enclosure

- individual use
- with predetermined breaking point for M16 cable glands
- without predetermined breaking point for the use with radio systems or special connectors



### → Assembled M12 enclosure

- for conventional wiring
- two M12 connectors
- the emergency-stop is connected separately via the second M12 connector



### → Assembled IO-Link enclosure

- IO-Link certified
- two M12 connectors (IO-Link / emergency-stop (AIDA))
- IO-Link status indication
- The following features can be parameterised:
  - dimming or night design of all LEDs
  - operating hours meter
  - monitoring of switching cycles (lifetime) of each pushbutton or switch
  - monitoring of the status indication







### → Assembled AS-Interface enclosure

- AS-Interface certified
- two M12 connectors (bus is looped through)
- AS-Interface status indication
- Safety@Work (emergency-stop)



### → Assembled enclosure with sWave® radio technology

#### Transmitter

- sWave® technology of steute
- frequency range 868 MHz (EU and China)
- bidirectional communication (transmitter electronics with long-life battery)
- LED for status indication (monitoring of switching states and battery)
- range of up to 450 m in the open field and up to 40 m indoors

#### Receiver

- sWave® technology of steute
- frequency range 868 MHz (EU and China)
- 4 potential-free relay outputs (NO)
- learning mode (assignment of outputs)
- LED status indication (switching states)
- range of up to 450 m in the open field and up to 40 m indoors



## Insulated plastic enclosures

Illustration      Dimensions      Description      Type

IP65

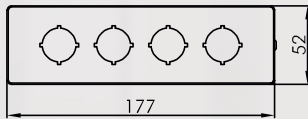
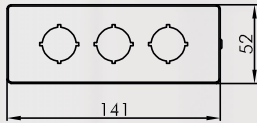
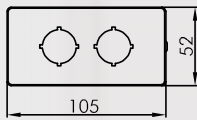
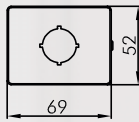

### Empty enclosure with predetermined breaking point

for pushbuttons and switches of the SHORTRON series

Equipped	no	
Material	PA6	
Cable entry	break-through wall M16	
Mounting holes	1	
Panel cut-out	Ø 22.3 mm	
colour	dark-grey bottom part/black cover	<b>PXD1</b>
Mounting holes	2	
Panel cut-out	Ø 22.3 mm	
colour	dark-grey bottom part/black cover	<b>PXD2</b>
Mounting holes	3	
Panel cut-out	Ø 22.3 mm	
colour	dark-grey bottom part/black cover	<b>PXD3</b>
Mounting holes	4	
Panel cut-out	Ø 22.3 mm	
Panel cut-out		
colour	dark-grey bottom part/black cover	<b>PXD4</b>

IP65

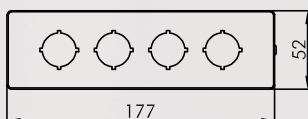
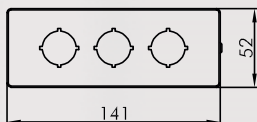
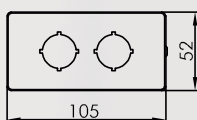
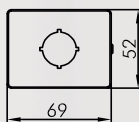
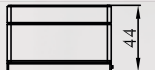

### Leergehäuse

Ohne Anschlussvorrichtung für eigene Anschlüsse oder Funk zur Selbstbestückung.

Bestückbar mit SHORTRON Befehlsgeräten.

Bestückt	nein	
Material	PA6	
Leitungseinführung		
Befehlsstellen	1	
Einbauöffnung	Ø 22,3 mm	
Farbe	Unterteil dunkelgrau/Oberteil schwarz	<b>PX01</b>
Mounting holes	2	
Panel cut-out	Ø 22.3 mm	
colour	dark-grey bottom part/black cover	<b>PX02</b>
Mounting holes	3	
Panel cut-out	Ø 22.3 mm	
colour	dark-grey bottom part/black cover	<b>PX03</b>
Mounting holes	4	
Panel cut-out	Ø 22.3 mm	
colour	dark-grey bottom part/black cover	<b>PX04</b>

**Equipped insulated plastic enclosures M12**

Illustration

Dimensions

Description

Type

IP65

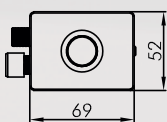

**Enclosure with M12 connector  
Pushbutton**

- equipped with 1 pushbutton RRJT (without nameplate, without lens)
- operating voltage 24 V AC/DC

Equipped            yes  
Material            PA6  
Cable entry        5-pole M12, A coded  
Mounting holes    1

**PXM1M0000**

IP65

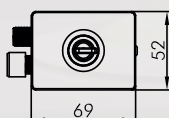
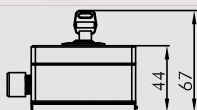

**Enclosure with M12 connector  
Key switch**

- equipped with 1 two-position key switch RRJSSA15
- operating voltage 24 V AC/DC

Equipped            yes  
Material            PA6  
Cable entry        5-pole M12, A coded  
Mounting holes    1

**PXM1M0001**

IP65

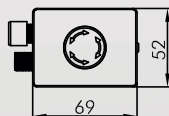
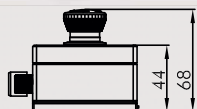

**Enclosure with M12 connector  
Emergency-stop**

- equipped with 1 emergency-stop RRJUV
- pin assignment emergency-stop: AIDA
- operating voltage 24 V AC/DC

Equipped            yes  
Material            PA6  
Cable entry        5-pole M12, A coded, AIDA  
Mounting holes    1

**PXM1M1000**

About Us

Pushbuttons/Switches

Panel Mount Jacks

Emergency-Stop Buttons

Bus Technology

RFID

Enclosures

Pedal Switches

Terminal Blocks

Type Index

Equipped insulated plastic enclosures M12

Illustration

Dimensions

Description

Type

IP65

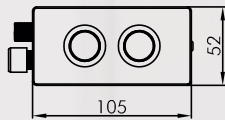

**Enclosure with M12 connector  
2 pushbuttons**

- equipped with 2 pushbuttons RRJT (without nameplate, without lens)
- operating voltage 24 V AC/DC

Equipped yes  
Material PA6  
Cable entry 8-pole M12, A coded

Mounting holes 2

PXM2M0002

IP65

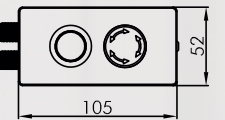

**Enclosure with M12 connector  
Pushbutton, emergency-stop**

- equipped with 1 pushbutton RRJT (without nameplate, without lens) and 1 emergency-stop RRJUV
- pin assignment emergency-stop: AIDA
- operating voltage 24 V AC/DC

Equipped yes  
Material PA6  
Cable entry 2x M12 5-pole (AIDA)/5 pole, A coded

Mounting holes 2

PXM2M1001

IP65

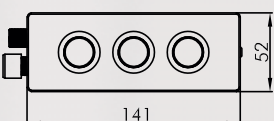
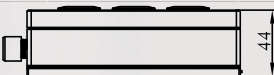

**Enclosure with M12 connector  
3 pushbuttons**

- equipped with 3 pushbuttons RRJT (without nameplate, without lens)
- operating voltage 24 V AC/DC

Equipped yes  
Material PA6  
Cable entry 12-pole M12, A coded

Mounting holes 3

PXM3M0003

Equipped insulated plastic enclosures M12

Illustration

Dimensions

Description

Type

IP65

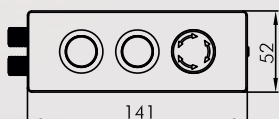
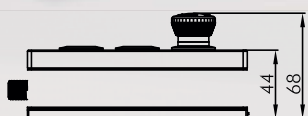

**Enclosure with M12 connector  
2 pushbuttons, emergency-stop**

- equipped with 2 pushbuttons RRJT (without nameplate, without lens) and 1 emergency-stop RRJUV
- pin assignment emergency-stop: AIDA
- operating voltage 24 V AC/DC

Equipped	yes
Material	PA6
Cable entry	2x M12 5-pole (AIDA)/8-pole, A coded
Mounting holes	3

PXM3M1002

IP65

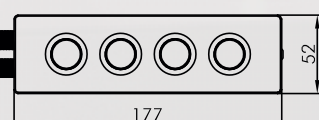
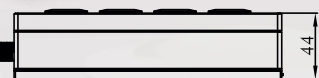

**Enclosure with M12 connector  
4 pushbuttons**

- equipped with 4 pushbuttons RRJT (without nameplate, without lens)
- operating voltage 24 V AC/DC

Equipped	yes
Material	PA6
Cable entry	2x M12 8-pole, A coded
Mounting holes	4

PXM4M0004

IP65

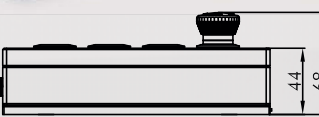

**Enclosure with M12 connector  
3 pushbuttons, emergency-stop**

- equipped with 3 pushbuttons RRJT (without nameplate, without lens) and 1 emergency-stop RRJUV
- pin assignment emergency-stop: AIDA
- operating voltage 24 V AC/DC

Equipped	yes
Material	PA6
Cable entry	2x M12 5-pole (AIDA)/12-pole, A coded
Mounting holes	4

PXM4M1003

Equipped insulated plastic enclosures M12

Illustration

Dimensions

Description

Type

IP65



**Enclosure with M12 connector  
Key switch, 2 pushbuttons, emergency-stop**

- equipped with 1 key switch RRJSSA15, 2 pushbuttons RRJT (without nameplate, without lens) and 1 emergency-stop RRJUV
- pin assignment emergency-stop: AIDA
- operating voltage 24 V AC/DC

Equipped                    yes  
Material                    PA6  
Cable entry                2x M12 5-pole (AIDA)/12-pole, A coded

Mounting holes            4

PXM4M1004

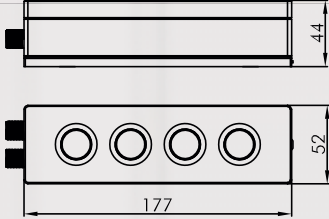

**customised configuration of the proboxx  
under [proboxx.schlegel.biz](http://proboxx.schlegel.biz)**



Equipped insulated plastic enclosures IO-Link



Illustration

Dimensions

Description

Type

IP65

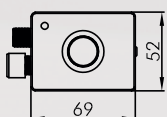

**Enclosure for IO-Link interface Pushbutton**

- IO-Link certified
- equipped with 1 pushbutton ST (without nameplate, without lens)
- IO-Link status indication
- IODD file via IODD finder
- class A

Parameterisation

- dimming and night design of all LEDs
- operating hours meter
- monitoring of switching cycles of each pushbutton or switch
- monitoring of status indication

Equipped	yes
Material	PA6
Cable entry	5-pole M12, A coded
Mounting holes	1

PXI1M0005

IP65

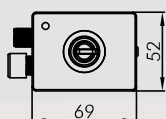
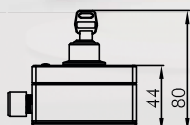

**Enclosure for IO-Link interface Key switch**

- IO-Link certified
- equipped with 1 key switch SSSA15
- IO-Link status indication
- IODD file via IODD finder
- class A

Parameterisation

- operating hours meter
- monitoring of switching cycles of each pushbutton or switch
- monitoring of status indication

Equipped	yes
Material	PA6
Cable entry	5-pole M12, A coded
Mounting holes	1

PXI1M0006

IP65

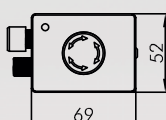
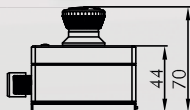

**Enclosure for IO-Link interface Emergency-stop**

- equipped with 1 emergency-stop FRVKZ
- pin assignment emergency-stop: AIDA

Equipped	yes
Material	PA6
Cable entry	5-pole M12, A coded, AIDA
Mounting holes	1

PXI1M1005



Equipped insulated plastic enclosures IO-Link

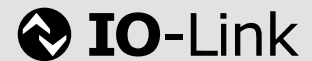

Illustration

Dimensions

Description

Type

IP65

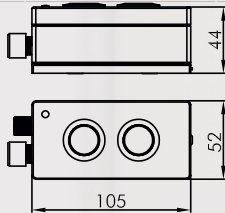

**Enclosure for IO-Link interface  
2 pushbuttons**

- IO-Link certified
- equipped with 2 pushbuttons ST (without nameplate, without lens)
- IO-Link status indication
- IODD file via IODD finder
- class A

Parameterisation

- dimming and night design of all LEDs
- operating hours meter
- monitoring of switching cycles of each pushbutton or switch
- monitoring of status indication

Equipped           yes  
Material           PA6  
Cable entry       5-pole M12, A coded

Mounting holes   2

PX12M0007

IP65

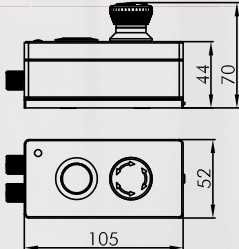

**Enclosure for IO-Link interface  
Pushbutton, emergency-stop**

- IO-Link certified
- equipped with 1 pushbutton ST (without nameplate, without lens) and 1 emergency-stop FRVKOO
- pin assignment emergency-stop: AIDA
- IO-Link status indication
- IODD file via IODD finder
- class A

Parameterisation

- dimming and night design of all LEDs
- operating hours meter
- monitoring of switching cycles of each pushbutton or switch
- monitoring of status indication

Equipped           yes  
Material           PA6  
Cable entry       2x M12 5-pole (AIDA)/5 pole, A coded

Mounting holes   2

PX12M1006

IP65

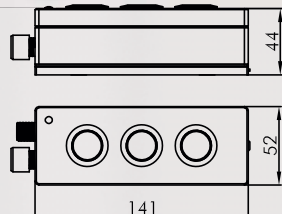

**Enclosure for IO-Link interface  
3 pushbuttons**

- IO-Link certified
- equipped with 3 pushbuttons ST (without nameplate, without lens)
- IO-Link status indication
- IODD file via IODD finder
- class A

Parameterisation

- dimming and night design of all LEDs
- operating hours meter
- monitoring of switching cycles of each pushbutton or switch
- monitoring of status indication

Equipped           yes  
Material           PA6  
Cable entry       5-pole M12, A coded

Mounting holes   3

PX13M0008

Equipped insulated plastic enclosures IO-Link

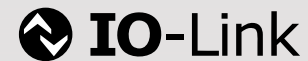

Illustration

Dimensions

Description

Type

IP65

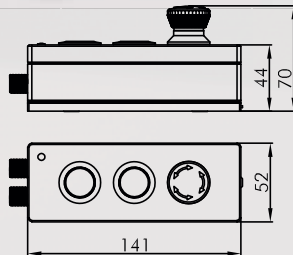

**Enclosure for IO-Link interface  
2 pushbuttons, emergency-stop**

- IO-Link certified
- equipped with 2 pushbuttons ST (without nameplate, without lens) and 1 emergency-stop FRVKOO
- pin assignment emergency-stop: AIDA
- IO-Link status indication
- IODD file via IODD finder
- class A

Parameterisation

- dimming and night design of all LEDs
- operating hours meter
- monitoring of switching cycles of each pushbutton or switch
- monitoring of status indication

Equipped            yes  
Material            PA6  
Cable entry        2x M12 5-pole (AIDA)/5 pole, A coded

Mounting holes    3

PXI3M1007

IP65

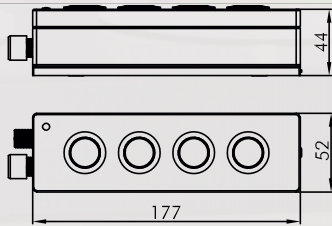

**Enclosure for IO-Link interface  
4 pushbuttons**

- IO-Link certified
- equipped with 4 pushbuttons ST (without nameplate, without lens)
- IO-Link status indication
- IODD file via IODD finder
- class A

Parameterisation

- dimming and night design of all LEDs
- operating hours meter
- monitoring of switching cycles of each pushbutton or switch
- monitoring of status indication

Equipped            yes  
Material            PA6  
Cable entry        5-pole M12, A coded

Mounting holes    4

PXI4M0009

Equipped insulated plastic enclosures IO-Link

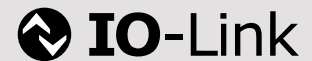

Illustration

Dimensions

Description

Type

IP65

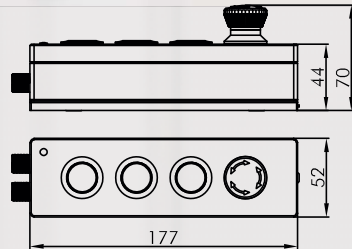

**Enclosure for IO-Link interface  
3 pushbuttons, emergency-stop**

- IO-Link certified
- equipped with 3 pushbuttons ST (without nameplate, without lens) and 1 emergency-stop FRVKOO
- pin assignment emergency-stop: AIDA
- IO-Link status indication
- IODD file via IODD finder
- class A

Parameterisation

- dimming and night design of all LEDs
- operating hours meter
- monitoring of switching cycles of each pushbutton or switch
- monitoring of status indication

Equipped            yes  
Material            PA6  
Cable entry        2x M12 5-pole (AIDA)/5 pole, A coded

Mounting holes    4

PXI4M1008

IP65

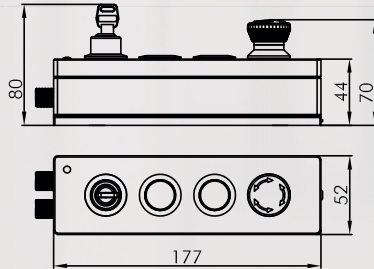

**Enclosure for IO-Link interface  
Key switch, 2 pushbuttons, emergency-stop**

- IO-Link certified
- equipped with 1 key switch SSSA15, 2 pushbuttons ST (without nameplate, without lens) and 1 emergency-stop FRVKOO
- pin assignment emergency-stop: AIDA
- IO-Link status indication
- IODD file via IODD finder
- class A

Parameterisation

- dimming and night design of all LEDs
- operating hours meter
- monitoring of switching cycles of each pushbutton or switch
- monitoring of status indication

Equipped            yes  
Material            PA6  
Cable entry        2x M12 5-pole (AIDA)/5 pole, A coded

Mounting holes    4

PXI4M1009

**customised configuration of the proboxx  
under [proboxx.schlegel.biz](http://proboxx.schlegel.biz)**

**Equipped insulated plastic enclosures AS-Interface**



Illustration      Dimensions      Description      Type

IP65

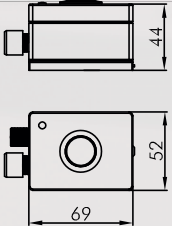
**Enclosure with AS-i interface Pushbutton**

- AS-Interface certified
- equipped with 1 pushbutton ST (without nameplate, without lens)
- specification 3.0 / 1A/B address
- profile S-7.A.7.7
- ASI status indication
- total power consumption  $\leq 200$  mA

Equipped      yes  
Material      PA6  
Cable entry      2x M12 5-pole, A coded  
Mounting holes      1

PXA1M0010

IP65

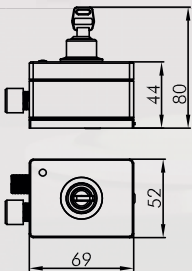
**Enclosure with AS-i interface Key switch**

- AS-Interface certified
- equipped with 1 key switch SSSA15
- specification 3.0 / 1A/B address
- profile S-7.A.7.7
- ASI status indication
- total power consumption  $\leq 200$  mA

Equipped      yes  
Material      PA6  
Cable entry      2x M12 5-pole, A coded  
Mounting holes      1

PXA1M0011

IP65

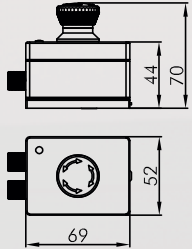
**Enclosure with AS-i interface Emergency-stop**

- AS-Interface certified
- equipped with 1 emergency-stop FRVKZ
- Safety@Work
- specification 2.1
- profile S-7.B.E
- ASI status indication
- total power consumption  $\leq 200$  mA

Equipped      yes  
Material      PA6  
Cable entry      2x M12 5-pole, A coded  
Mounting holes      1

PXA1M1010

Equipped insulated plastic enclosures AS-Interface



Illustration      Dimensions      Description      Type

IP65

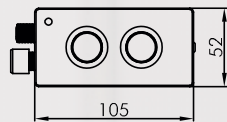
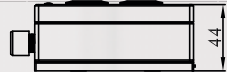

**Enclosure with AS-i interface  
2 pushbuttons**

- AS-Interface certified
- equipped with 2 pushbuttons ST (without nameplate, without lens)
- specification 3.0 / 1A/B address
- profile S-7.A.7.7
- ASI status indication
- total power consumption ≤ 200 mA

Equipped      yes  
Material      PA6  
Cable entry      2x M12 5-pole, A coded  
Mounting holes      2

PXA2M0012

IP65

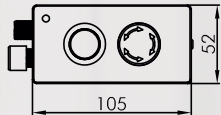

**Enclosure with AS-i interface  
Pushbutton, emergency-stop**

- AS-Interface certified
- equipped with 1 pushbutton ST (without nameplate, without lens) and 1 emergency-stop FRVKOO
- specification 3.0 / 1A/B address
- profile S-7.A.7.7
- Safety@Work (emergency-stop)
- specification 2.1
- profile S-7.B.E
- ASI status indication
- total power consumption ≤ 200 mA

Equipped      yes  
Material      PA6  
Cable entry      2x M12 5-pole, A coded  
Mounting holes      2

PXA2M1011

IP65

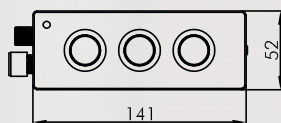
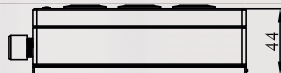

**Enclosure with AS-i interface  
3 pushbuttons**

- AS-Interface certified
- equipped with 3 pushbuttons ST (without nameplate, without lens)
- specification 3.0 / 1A/B address
- profile S-7.A.7.7
- ASI status indication
- total power consumption ≤ 200 mA

Equipped      yes  
Material      PA6  
Cable entry      2x M12 5-pole, A coded  
Mounting holes      3

PXA3M0013



Equipped insulated plastic enclosures AS-Interface



Illustration

Dimensions

Description

Type

IP65



**Enclosure with AS-i interface  
2 pushbuttons, emergency-stop**

- AS-Interface certified
  - equipped with 2 pushbuttons ST (without nameplate, without lens) and 1 emergency-stop FRVKKO
  - specification 3.0 / 1A/B address
  - profile S-7.A.7.7
  - Safety@Work (emergency-stop)
  - specification 2.1
  - profile S-7.B.E
  - ASI status indication
  - total power consumption  $\leq 200$  mA
- |                |                        |
|----------------|------------------------|
| Equipped       | yes                    |
| Material       | PA6                    |
| Cable entry    | 2x M12 5-pole, A coded |
| Mounting holes | 3                      |

PXA3M1012

IP65



**Enclosure with AS-i interface  
4 pushbuttons**

- AS-Interface certified
  - equipped with 4 pushbuttons ST (without nameplate, without lens)
  - specification 3.0 / 1A/B address
  - profile S-7.A.7.7
  - ASI status indication
  - total power consumption  $\leq 200$  mA
- |                |                        |
|----------------|------------------------|
| Equipped       | yes                    |
| Material       | PA6                    |
| Cable entry    | 2x M12 5-pole, A coded |
| Mounting holes | 4                      |

PXA4M0014

IP65



**Enclosure with AS-i interface  
3 pushbuttons, emergency-stop**

- AS-Interface certified
  - equipped with 3 pushbuttons ST (without nameplate, without lens) and 1 emergency-stop FRVKKO
  - specification 3.0 / 1A/B address
  - profile S-7.A.7.7
  - Safety@Work (emergency-stop)
  - specification 2.1
  - profile S-7.B.E
  - ASI status indication
  - total power consumption  $\leq 200$  mA
- |                |                        |
|----------------|------------------------|
| Equipped       | yes                    |
| Material       | PA6                    |
| Cable entry    | 2x M12 5-pole, A coded |
| Mounting holes | 4                      |

PXA4M1013

Equipped insulated plastic enclosures AS-Interface



Illustration

Dimensions

Description

Type

IP65

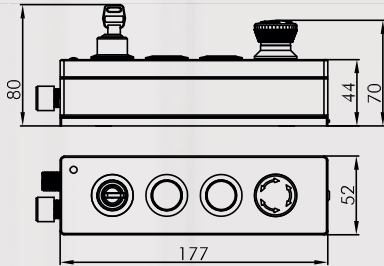

**Enclosure with AS-i interface  
Key switch, 2 pushbuttons, emergency-stop**

- AS-Interface certified
- equipped with 1 key switch SSSA15, 2 pushbuttons ST (without nameplate, without lens) and 1 emergency-stop FRVKKO
- specification 3.0 / 1A/B address
- profile S-7.A.7.7
- Safety@Work (emergency-stop)
- specification 2.1
- profile S-7.B.E
- ASI status indication
- total power consumption ≤ 200 mA

Equipped	yes
Material	PA6
Cable entry	2x M12 5-pole, A coded
Mounting holes	4

PXA4M1014

**customised configuration of the proboxx  
under [proboxx.schlegel.biz](http://proboxx.schlegel.biz)**



Equipped insulated plastic enclosures with sWave® radio technology

sWave®

Illustration

Dimensions

Description

Type

IP65

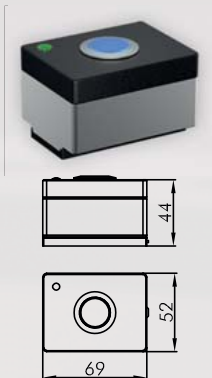

**Enclosure with radio technology  
Pushbutton**

- equipped with 1 pushbutton ST (without nameplate, without lens)
- sWave® radio technology
- frequency 868.3 MHz (EU, China)
- long-life battery + performance monitoring
- bidirectional communication
- LED status indication
- range of up to 450 m in the open field and up to 40 m indoors

Equipped            yes  
Material            PA6

Mounting holes    1

PXF1M0015

IP65

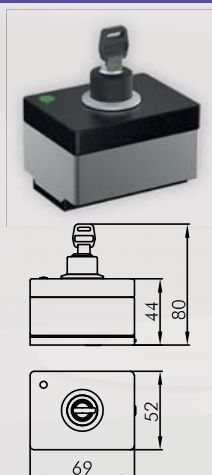

**Enclosure with radio technology  
Key switch**

- equipped with 1 key switch SSSA15
- sWave® radio technology
- frequency 868.3 MHz (EU, China)
- long-life battery + performance monitoring
- bidirectional communication
- LED status indication
- range of up to 450 m in the open field and up to 40 m indoors

Equipped            yes  
Material            PA6

Mounting holes    1

PXF1M0016

IP65

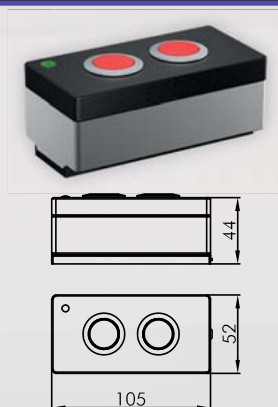

**Enclosure with radio technology  
2 pushbuttons**

- equipped with 2 pushbuttons ST (without nameplate, without lens)
- sWave® radio technology
- frequency 868.3 MHz (EU, China)
- long-life battery + performance monitoring
- bidirectional communication
- LED status indication
- range of up to 450 m in the open field and up to 40 m indoors

Equipped            yes  
Material            PA6

Mounting holes    2

PXF2M0017

About Us

Pushbuttons / Switches

Panel Mount Jacks

Emergency-Stop Buttons

Bus Technology

RFID

→ Enclosures

Pedal Switches

Terminal Blocks

Type Index

Equipped insulated plastic enclosures with sWave® radio technology

sWave®

Illustration

Dimensions

Description

Type

IP65

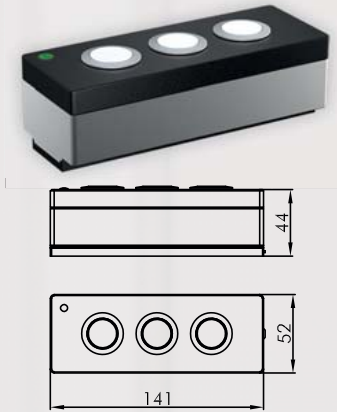

**Enclosure with radio technology  
3 pushbuttons**

- equipped with 3 pushbuttons ST (without nameplate, without lens)
- sWave® radio technology
- frequency 868.3 MHz (EU, China)
- long-life battery + performance monitoring
- bidirectional communication
- LED status indication
- range of up to 450 m in the open field and up to 40 m indoors

Equipped            yes  
Material            PA6

Mounting holes    3

PXF3M0018

IP65

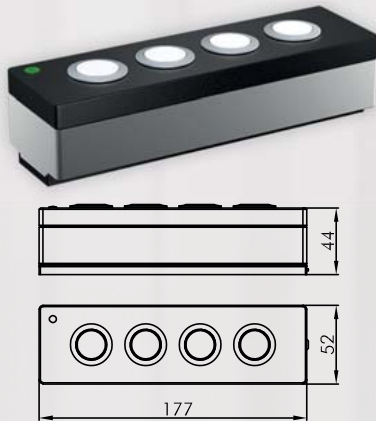

**Enclosure with radio technology  
4 pushbuttons**

- equipped with 4 pushbuttons ST (without nameplate, without lens)
- sWave® radio technology
- frequency 868.3 MHz (EU, China)
- long-life battery + performance monitoring
- bidirectional communication
- LED status indication
- range of up to 450 m in the open field and up to 40 m indoors

Equipped            yes  
Material            PA6

Mounting holes    4

PXF4M0019

IP20



**Radio receiver**

- sWave® radio technology
- frequency 868.3 MHz (EU, China)
- 4 radio channels
- 4 NO, max. 3 A
- Ui 250 VAC
- operating voltage 24 VDC
- potential-free relay outputs
- LED status indication
- learning mode
- for fitting on top-hat rail
- range of up to 450 m in the open field and up to 40 m indoors





PXFE868

customised configuration of the proboxx  
under [proboxx.schlegel.biz](http://proboxx.schlegel.biz)

Accessories for pushbuttons and switches

Illustration	Dimensions	Description	Type
		<p><b>Flat lens, non-transparent</b></p> <p>colour</p> <ul style="list-style-type: none"> <li>blue</li> <li>yellow</li> <li>green</li> <li>black</li> <li>red</li> <li>white</li> </ul>	<ul style="list-style-type: none"> <li> T22RRGBL</li> <li> T22RRGGB</li> <li> T22RRGGN</li> <li> T22RRGSW</li> <li> T22RRGRT</li> <li> T22RRGWS</li> </ul>
		<p><b>Flat lens, transparent</b></p> <p>colour</p> <ul style="list-style-type: none"> <li>blue</li> <li>yellow</li> <li>green</li> <li>clear</li> <li>red</li> </ul>	<ul style="list-style-type: none"> <li> T22RRBL</li> <li> T22RRGB</li> <li> T22RRGN</li> <li> T22RRKL</li> <li> T22RRRT</li> </ul>
		<p><b>Blank nameplate</b></p>	BSRRU
		<p><b>Nameplate with standard imprint</b></p> <p>please specify index number (see nameplates in the product catalogue)</p>	BSRR...
		<p><b>Mounting bracket for enclosures with 1 pushbutton or switch</b></p> <p>for fixing the proboxx on a wall or on a profile</p> <p>Material plastic</p>	PXH1
		<p><b>Mounting bracket for enclosures with 2 pushbuttons or switches</b></p> <p>for fixing the proboxx on a wall or on a profile</p> <p>Material plastic</p>	PXH2

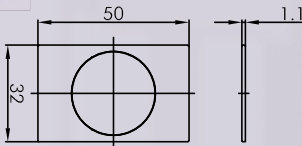
Accessories for pushbuttons and switches

Illustration	Dimensions	Description	Type
		<p><b>Mounting bracket for enclosures with 3 pushbuttons or switches</b></p> <p>for fixing the proboxx on a wall or on a profile</p> <p>Material plastic</p>	PXH3
		<p><b>Mounting bracket for enclosures with 4 pushbuttons or switches</b></p> <p>for fixing the proboxx on a wall or on a profile</p> <p>Material plastic</p>	PXH4
 		<p><b>Marking tag</b></p> <p>for labelling the pushbuttons and switches of the proboxx enclosure series</p> <ul style="list-style-type: none"> <li>- easy to mount, clip-on type</li> <li>- laser marking (as per customer's request)</li> </ul> <p>Material plastic</p> <p>colour black</p>	 PXABT
	IP65	<p><b>Cap</b></p> <p>screwable cap for unused M12 connection</p> <p>Material plastic</p>	PXSKM



[About Us](#)

[Pushbuttons/Switches](#)

[Panel Mount Jacks](#)

[Emergency-Stop Buttons](#)

[Bus Technology](#)

[RFID](#)

[→ Enclosures](#)

[Pedal Switches](#)

[Terminal Blocks](#)

[Type Index](#)



Georg Schlegel GmbH & Co. KG  
Kapellenweg 4  
88525 Dürmentingen / Germany

☎ +49 (0)7371 / 502-0  
📠 +49 (0)7371 / 502 49  
@ info@schlegel.biz  
[www.schlegel.biz](http://www.schlegel.biz)



### Subsidiaries:

Schlegel Elektrokontakt GmbH  
Schönbachstr. 93  
04299 Leipzig / **Germany**

Tel.: +49 (0)341 / 8 68 72-0  
Fax: +49 (0)341 / 8 68 72 43  
E-Mail: [leipzig@schlegel.biz](mailto:leipzig@schlegel.biz)  
[www.schlegel.biz](http://www.schlegel.biz)

Georg Schlegel Vertriebs Ges.mbH  
Samuel Morse-Straße 7  
2700 Wiener Neustadt / **Austria**

Tel.: +43 (0)2622 / 8 13 13  
Fax: +43 (0)2622 / 8 13 13-19  
E-Mail: [schlegel@schlegel.at](mailto:schlegel@schlegel.at)  
[www.schlegel.at](http://www.schlegel.at)